



INSTITUTO
SUPERIOR
TÉCNICO

INSTITUTO SUPERIOR TÉCNICO

DEPARTAMENTO DE ENGENHARIA MECÂNICA

DISCIPLINAS DE DESENHO I/II

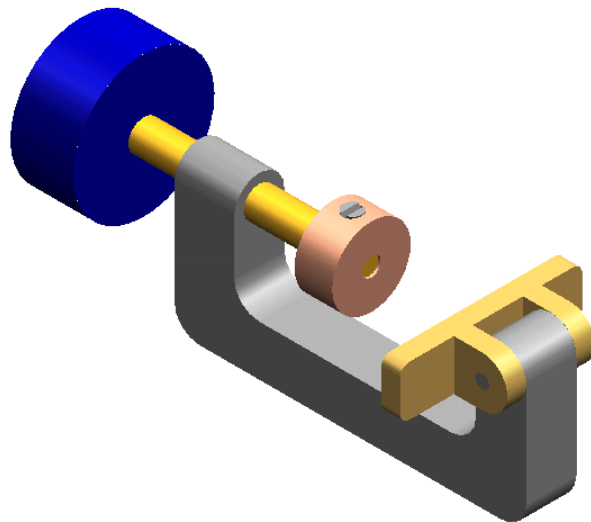

**NORMAS NP, ISO e EN
RELACIONADAS COM O
DESENHO TÉCNICO**

João M. Pereira Dias

**(Versão 1.3)
2000/1/4**

Janeiro de 2000

ÍNDICE

NORMAS <i>PORTUGUESAS</i> <i>NP</i> SOBRE DESENHO TÉCNICO	3
NORMAS <i>PORTUGUESAS</i> <i>NP</i> SOBRE TOLERANCIAMENTO	3
NORMAS <i>PORTUGUESAS</i> <i>NP</i> SOBRE SOLDADURA	4
NORMAS <i>PORTUGUESAS</i> <i>NP</i> SOBRE ACABAMENTOS SUPERFICIAIS E ESTADOS DE SUPERFÍCIE	4
NORMAS <i>PORTUGUESAS</i> <i>NP</i> SOBRE PEÇAS ROSCADAS	4
NORMAS <i>PORTUGUESAS</i> <i>NP</i> SOBRE REBITES	5
NORMAS <i>EUROPEIAS</i> <i>EN</i> SOBRE DESENHO TÉCNICO	6
NORMAS <i>EUROPEIAS</i> <i>EN</i> SOBRE TOLERANCIAMENTO	7
NORMAS <i>EUROPEIAS</i> <i>EN</i> SOBRE SOLDADURA	8
NORMAS EUROPEIAS EN RELACIONADAS COM PEÇAS ROSCADAS	8
NORMAS <i>EUROPEIAS</i> <i>EN</i> SOBRE ANILHAS	8
NORMAS <i>EUROPEIAS</i> <i>EN</i> SOBRE MOLAS	9
NORMAS <i>EUROPEIAS</i> <i>EN</i> SOBRE ROLAMENTOS	9
NORMAS <i>EUROPEIAS</i> <i>EN</i> SOBRE ENGRENAGENS	9
NORMAS <i>ISO</i> SOBRE DESENHO TÉCNICO	10
NORMAS <i>ISO</i> SOBRE TOLERANCIAMENTO DIMENSIONAL	14
NORMAS <i>ISO</i> SOBRE TOLERANCIAMENTO DIMENSIONAL DE PEÇAS ROSCADAS	15
NORMAS <i>ISO</i> SOBRE TOLERANCIAMENTO DIMENSIONAL DE ENGRENAGENS	16
NORMAS <i>ISO</i> SOBRE TOLERANCIAMENTO GEOMÉTRICO	16
NORMAS <i>ISO</i> SOBRE SOLDADURA	17
NORMAS <i>ISO</i> SOBRE ACABAMENTOS SUPERFICIAIS E ESTADOS DE SUPERFÍCIE	18
NORMAS <i>ISO</i> SOBRE PEÇAS ROSCADAS	19
NORMAS <i>ISO</i> SOBRE ANILHAS	25
NORMAS <i>ISO</i> SOBRE MOLAS	26
NORMAS <i>ISO</i> SOBRE ROLAMENTOS	26
NORMAS <i>ISO</i> SOBRE ENGRENAGENS	26
NORMAS <i>ISO</i> SOBRE PRODUTOS ESPECÍFICOS E INDIRECTAMENTE RELACIONADAS COM O DESENHO TÉCNICO	28
NORMAS <i>ISO</i> SOBRE SIMBOLOS GRÁFICOS USADOS NOS DESENHOS E EM DOCUMENTAÇÃO TÉCNICA EM GERAL	29
NORMAS <i>ISO</i> SOBRE DOCUMENTAÇÃO TÉCNICA DO PRODUTO	31
NORMAS <i>ISO</i> SOBRE QUALIDADE	32
NORMAS <i>ISO</i> SOBRE EQUIPAMENTO PARA DESENHO	34
ASPECTOS GERAIS RELACIONADOS COM AS NORMAS ISO	35
LISTA DAS NORMAS POR ORDEM ALFABÉTICA	37

NOTA: A **AZUL** (**underline e bold**) encontram-se assinaladas as normas disponíveis e actualizadas.

A **VERMELHO** (**Underline e itálico**) as normas disponíveis mas desactualizadas.

A *Verde* (Itálico) Norma não disponível mas existe equivalente da ISO

** Norma que vai ser adquirida (Livro ISO- *Limits, Fits and Surface Properties*)

NORMAS PORTUGUESAS *NP* SOBRE DESENHO TÉCNICO

[NP 48:1968 \(3ª Edição\)](#), Desenho técnico. Formatos.

[NP 49:1968 \(3ª Edição\)](#), Desenho técnico. Modo de dobrar folhas de desenho.

[NP 62:1961 \(2ª Edição\)](#), Desenho técnico. Linhas e sua utilização.

[NP 167:1966 \(2ª Edição\)](#) Desenho técnico. Figuração de materiais em corte.

[NP 204:1968 \(2ª Edição\)](#) Desenho técnico. Legendas.

[NP 205:1970 \(1ª Edição\)](#) Desenho técnico. Listas de peças.

NP 265:1962 (1ª Edição) Cotas não toleranciadas. Diferenças para peças metálicas trabalhadas por arranque de apara

[NP 297:1963 \(1ª Edição\)](#), Desenho técnico. Cotagem.

[NP 327:1964 \(1ª Edição\)](#), Desenho técnico. Representação de vistas.

[NP 328:1964 \(1ª Edição\)](#) Desenho técnico. Cortes e secções.

[NP 671:1973 \(1ª Edição\)](#) Desenho técnico. Representação convencional. Convenções de utilização geral

[NP 718:1968 \(2ª Edição\)](#) Desenho técnico. Esquadrias

NORMAS QUE DEIXARAM DE ESTAR EM VIGOR:

- 89, 717 (Escalas)

NORMAS PORTUGUESAS *NP* SOBRE TOLERANCIAMENTO

NP 107:1962 (1ª Edição) Tolerâncias e ajustamentos. Terminologia

[NP 189:1962 \(1ª Edição\)](#) Sistema de tolerâncias. Noções fundamentais.

[NP 190:1963 \(1ª Edição\)](#) Sistema de tolerâncias. Simbologia.

NP 366:1964 (1ª Edição) Enchavetamentos. Tolerâncias na largura dos escatéis

[NP 716:1968 \(1ª Edição\)](#) Desenho técnico. Cotagem e especificação de tolerâncias de elementos cónicos

NP 1895:1982 (1ª Edição) Roscas métricas de perfil triangular ISO para usos gerais. Tolerâncias. Generalidades CORRESPONDÊNCIA: ISO 965-1:1980 EQV

NP 1896:1982 (1ª Edição) Roscas métricas de perfil triangular ISO para usos gerais. Tolerâncias. Dimensões limites. Qualidade média CORRESPONDÊNCIA: ISO 965-2:1980 EQV

NP 1897:1982 (1ª Edição) Roscas métricas de perfil triangular ISO para usos gerais. Tolerâncias. Desvios CORRESPONDÊNCIA: ISO 965-3:1980 EQV

NORMAS PORTUGUESAS *NP* SOBRE SOLDADURA

NP 1515:1977 (1ª Edição) Soldadura. Representação simbólica nos desenhos CORRESPONDÊNCIA: ISO 2553:1974

NORMAS PORTUGUESAS *NP* SOBRE ACABAMENTOS SUPERFICIAIS E ESTADOS DE SUPERFÍCIE

NP 3915-1:1994 (1ª Edição) Rugosidade de superfícies. Terminologia. Parte 1: Superfície e seus parâmetros. (CORRESPONDÊNCIA: ISO 4287-1:1984 –Desactualizada existe Ed. 97)

NP 3915-2:1994 (1ª Edição) Rugosidade de superfícies. Terminologia. Parte 2: Medição dos parâmetros de rugosidade de superfície (CORRESPONDÊNCIA: ISO 4287-2:1984 – Desactualizada existe Ed. 97)

NORMAS PORTUGUESAS *NP* SOBRE PEÇAS ROSCADAS

NP 110:1983 (2ª Edição) Roscas métricas de perfil triangular ISO para usos gerais. Diâmetros e passos recomendados (CORRESPONDÊNCIA: ISO 262:1973- Desactualizada)

NP 155:1985 (3ª Edição) Elementos de ligação roscados e seus acessórios. Nomenclatura CORRESPONDÊNCIA: ISO 1891:1979 EQV

NP 400:1983 (2ª Edição) Roscas métricas de perfil triangular ISO para usos gerais. Perfil de base CORRESPONDÊNCIA: ISO 68:1973 EQV. (Disponível edição 1965).

NP 401:1983 (2ª Edição) Roscas métricas de perfil triangular ISO para usos gerais. Dimensões nominais CORRESPONDÊNCIA: ISO 261:1973 EQV;ISO 724:1978 EQV (Disponível edição 1965).

- NP 1899:1982 (1ª Edição) Parafusos de aço, sem cabeça. Características mecânicas
CORRESPONDÊNCIA: ISO 898-5:1980 EQV
- NP 1900:1982 (1ª Edição) Parafusos de cabeça sextavada, parcialmente roscados. Graus de
acabamento A e B CORRESPONDÊNCIA: ISO 4014:1979 EQV*

NORMAS PORTUGUESAS *NP* SOBRE REBITES

- NP 245:1961 (1ª Edição) Rebites semitubulares com cabeça esférica e 3 a 5 mm de diâmetro
- NP 246:1961 (1ª Edição) Rebites semitubulares com cabeça contrapunçoadada plana e 3 a 5 mm
de diâmetro
- NP 247:1961 (1ª Edição) Rebites semitubulares com cabeça cilíndrica chata e 3 a 6,3 mm de
diâmetro
- NP 248:1961 (1ª Edição) Rebites bifurcados com cabeça contrapunçoadada plana e 3 a 5mm de
diâmetro
- NP 249:1961 (1ª Edição) Rebites com cabeça esférica e 1,6 a 9 mm de diâmetro
- NP 250:1961 (1ª Edição) Rebites com cabeça contrapunçoadada plana e 1,6 a 9 mm de diâmetro
- NP 251:1961 (1ª Edição)** Rebites com cabeça cilíndrica chata e 1,6 a 9 mm de diâmetro
- NP 252:1961 (1ª Edição) Furos para rebites
- NP 264:1962 (1ª Edição) Rebites. Tipos normalizados

NORMAS EUROPEIAS EN SOBRE DESENHO TÉCNICO

- EN 2851:1992 Série aeroespacial. Marcação de peças e conjuntos, excepto motores. Indicação nos desenhos
- EN 20898-1:1991 Propriedades mecânicas dos elementos de ligação. Parte 1: Parafusos de cabeça, parafusos com fenda e pernos CORRESPONDÊNCIA: ISO 898-1:1988.
- EN ISO 4172:1996 Technical drawings. Construction drawings. Drawings for the assembly of prefabricated structures CORRESPONDÊNCIA: ISO 4172:1991
- EN ISO 5455:1994 Technical drawings. Scales (Substitui a NP 717)
- EN ISO 5457:1999 Technical product documentation. Sizes and layout of drawing sheets (ISO 5457:1999)
- EN ISO 6410-1:1996 Technical drawings. Screw threads and threaded parts. Part 1: General conventions CORRESPONDÊNCIA: ISO 6410-1:1993
- EN ISO 6410-2:1996 Technical drawings. Screw threads and threaded parts. Part 2: Screw thread inserts CORRESPONDÊNCIA: ISO 6410-2:1993
- EN ISO 6410-3:1996 Technical drawings. Screw threads and threaded parts. Part 3: Simplified representation CORRESPONDÊNCIA: ISO 6410-3:1993
- EN ISO 6411:1997 Technical drawings. Simplified representation of centre holes CORRESPONDÊNCIA: ISO 6411:1982
- EN ISO 6412-1:1994 Technical drawings. Simplified representation of pipelines. Part 1: General rules and orthogonal representation CORRESPONDÊNCIA: ISO 6412-1:1989
- EN ISO 6412-2:1994 Technical drawings. Simplified representation of pipelines. Part 2: Isometric projection. CORRESPONDÊNCIA: ISO 6412-2:1989
- EN ISO 6412-3:1996 Technical drawings. Simplified representation of pipelines. Part 3: Terminal features of ventilation and drainage systems CORRESPONDÊNCIA: ISO 6412-3:1993
- EN ISO 6413:1994 Technical drawings. Representation of splines and serrations CORRESPONDÊNCIA: ISO 6413:1988
- EN ISO 6414:1994 Technical drawings for glassware CORRESPONDÊNCIA: ISO 6414:1982
- EN ISO 6433:1994 Technical drawings. Item references CORRESPONDÊNCIA: ISO 6433:1981

- EN ISO 7437:1996 Technical drawings. Construction drawings. General rules for execution of production drawings for prefabricated structural components
CORRESPONDÊNCIA: ISO 7437:1990
- EN ISO 7519:1996 Technical drawings. Construction drawings. general principles of presentation for general arrangement and assembly drawings
CORRESPONDÊNCIA: ISO 7519:1991
- EN ISO 9222-1:1995 Technical drawings. Seals for dynamic application. Part 1: General simplified representation
CORRESPONDÊNCIA: ISO 9222-1:1989
- EN ISO 9222-2:1994 Technical drawings. Seals of dynamic application. Part 2: Detailed simplified representation
CORRESPONDÊNCIA: ISO 9222-2:1989

NORMAS EUROPEIAS *EN* SOBRE TOLERANCIAMENTO

- EN 20286-1:1993 Sistema ISO de tolerâncias e de ajustamento. Parte 1: Base de tolerâncias, desvios e ajustamentos
CORRESPONDÊNCIA: ISO 286-1:1988
- EN 20286-2:1993 Sistema ISO de tolerâncias e de ajustamentos. Parte 2: Tabelas dos graus de tolerância normalizados e dos desvios limites dos furos e dos veios
CORRESPONDÊNCIA: ISO 286-2:1988
- EN 22768-1:1993. General tolerances. Part 1: Tolerances for linear and angular dimensions without individual tolerance indications
CORRESPONDÊNCIA: ISO 2768-1:1989
- EN 22768-2:1993. General tolerances. Part 2: Geometrical tolerances without individual tolerances indications
CORRESPONDÊNCIA: ISO 2768-2:1989
- EN ISO 7083:1994* Technical drawings. Symbols for geometrical tolerancing. Proportions and dimensions. CORRESPONDÊNCIA: [ISO 7083:1983](#)

NORMAS EUROPEIAS **EN** SOBRE SOLDADURA

EN 2574:1990 Série aeroespacial. Soldaduras. Informações nos desenhos

EN 22553:1994 Welded, brazed and soldered joints. Symbolic representation on drawings
CORRESPONDÊNCIA: [ISO 2553:1992](#)

EN 24063:1992 Welding, brazing, soldering and braze welding of metals. Nomenclature of processes and reference numbers for symbolic representation on drawings
CORRESPONDÊNCIA: [ISO 4063:1990](#)

NORMAS EUROPEIAS EN RELACIONADAS COM PEÇAS ROSCADAS

[EN 24014:1991](#) Hexagon head bolts. Product grades A and B CORRESPONDÊNCIA: ISO 4014:1988 (Catálogo Mattsons)

EN 24015:1991 Hexagon head bolts. Product grade B. Reduced shank (Shank diameter = pitch diameter) CORRESPONDÊNCIA: ISO 4015:1979.

EN 24016:1991 Hexagon head bolts. Product grade C CORRESPONDÊNCIA: ISO 4016:1988

EN 24017:1991 Hexagon head screws. Product grades A and B CORRESPONDÊNCIA: ISO 4017:1988

EN 24018:1991 Hexagon head screws. Product grade C CORRESPONDÊNCIA: ISO 4018:1988

EN 28676:1991 Hexagon head screws with metric fine pitch thread. Product grades A and B
CORRESPONDÊNCIA: ISO 8676:1988

NORMAS EUROPEIAS **EN** SOBRE ANILHAS

EN ISO 10644:1998 Screw and washer assemblies with plain washers. Washer hardness classes 200 HV and 300 HV CORRESPONDÊNCIA: ISO 10644:1998

EN ISO 10673:1998 Plain washers for screw and washer assemblies. Small, normal and large series. Product grade A CORRESPONDÊNCIA: ISO 10673:1998

EN 28738:1992 Plain washers for clevis pins. Product grade A. CORRESPONDÊNCIA: ISO 8738:1986

NORMAS EUROPEIAS *EN* SOBRE MOLAS

EN ISO 2162-1:1996 Technical product documentation. Springs. Part 1: Simplified representation CORRESPONDÊNCIA: [ISO 2162-1:1993](#)

EN ISO 2162-2:1996 Technical product documentation. Springs. Part 2: Presentation of data for cylindrical helical compression springs CORRESPONDÊNCIA: [ISO 2162-2:1993](#)

EN ISO 2162-3:1996 Technical product documentation. Springs. Part 3: Vocabulary CORRESPONDÊNCIA: [ISO 2162-3:1993](#)

NORMAS EUROPEIAS *EN* SOBRE ROLAMENTOS

EN ISO 8826-1:1995 Technical drawings. Rolling bearings. Part 1: General simplified representation CORRESPONDÊNCIA: [ISO 8826-1:1989](#)

EN ISO 8826-2:1997 Technical drawings. Rolling bearings. Part 2: Detailed simplified representation CORRESPONDÊNCIA: [ISO 8826-2:1994](#)

NORMAS EUROPEIAS *EN* SOBRE ENGRENAGENS

EN ISO 2203:1997 Technical drawings. Conventional representation of gears CORRESPONDÊNCIA: [ISO 2203:1973](#)

NORMAS **ISO** SOBRE DESENHO TÉCNICO

[ISO 128:1982](#) Technical drawings - General principles of presentation . (ISO Book)

ISO/CD 128-1 Technical drawings -- General principles of presentation -- Part 1: Basic information and indexes (Ed. 1) . (ISO Book)

[ISO 128-20:1996](#) Technical drawings - General principles of presentation - Part 20: Basic conventions for lines . (ISO Book)

[ISO 128-21:1997](#) Technical drawings - General principles of presentation - Part 21: Preparation of lines by CAD systems . (ISO Book)

ISO 128-22:1999 Technical drawings -- General principles of presentation -- Part 22: Basic conventions and applications for leader lines and reference lines (Ed. 1, 8 p, D)

ISO 128-23:1999 Technical drawings -- General principles of presentation -- Part 23: Lines on construction drawings (Ed.1, 12 p, F)

ISO 128-24:1999 Technical drawings -- General principles of presentation -- Part 24: Lines on mechanical engineering drawings (Ed. 1, 13 p, G)

ISO 128-25:1999 Technical drawings -- General principles of presentation -- Part 25: Lines on shipbuilding drawings (Ed. 1, 10 p, E)

ISO/DIS 128-30.2 Technical drawings -- General principles of presentation -- Part 30: Basic conventions for views (Ed. 1, 7 p)

ISO/DIS 128-40 Technical drawings -- General principles of presentation -- Part 40: Basic conventions for cuts and sections (Ed. 1, 5 p)

ISO/DIS 128-41 Technical drawings -- General principles of presentation -- Part 41: Cuts and sections for mechanical engineering drawings (Ed. 1, 8 p)

ISO/DIS 128-50.2 Technical drawings -- General principles of presentation -- Part 50: Basic conventions for representing areas on cuts and sections (Ed. 1, 5 p)

ISO/DIS 128-60 Technical drawings -- General principles of presentation -- Part 60: Additional conventions for views, cuts and sections (Ed. 1, 9 p)

ISO/CD 128-71 Technical drawings -- General principles of presentation -- Part 71: Simplified representation for mechanical engineering (Ed. 1)

[ISO 129:1985](#) Technical drawings - Dimensioning - General principles, definitions, methods of execution and special indications. (ISO Book)

ISO/DIS 129-1 Technical drawings -- Indication of dimensions and tolerances -- Part 1: General principles (Ed. 1, 30 p)

- ISO/CD 129-2 Technical drawings -- Dimensioning -- Part 2: Mechanical engineering (Ed. 1)
- ISO 216:1975 Writing paper and certain classes of printed matter -- Trimmed sizes -- A and B series (Ed. 1, 3 p, B)
- [ISO 1302:1992](#) Technical drawings - Method of indicating surface texture (ISO Book)
- ISO/DIS 1302 Geometrical Product Specification (GPS) -- Indication of surface texture in technical product documentation (Ed. 4, 37 p)
- [ISO 2594:1972](#) Building drawings - Projection methods
- ISO 3098-0:1997 Technical product documentation - Lettering - Part 0: General requirements
- [ISO 3098-1:1974](#) Technical drawings - Lettering - Part 1: Currently used characters (ISO Book)
- [ISO 3098-2:1984](#) Technical drawings - Lettering - Part 2: Greek characters (ISO Book)
- [ISO 3098-3:1987](#) Technical drawings - Lettering - Part 3: Diacritical and particular marks for the Latin alphabet (ISO Book)
- [ISO 3098-4:1984](#) Technical drawings - Lettering - Part 4: Cyrillic characters (ISO Book)
- [ISO 3098-5:1997](#) Technical product documentation - Lettering - Part 5: CAD lettering of the Latin alphabet, numerals and marks (Disponível edição 1984).
- [ISO 3272-1:1983](#) Microfilming of technical drawings and other drawing office documents - Part 1: Operating procedures (ISO Book)
- [ISO 3272-2:1994](#) Microfilming of technical drawings and other drawing office documents - Part 2: Quality criteria and control of 35 mm silver gelatin microfilms (ISO Book)
- [ISO 3272-3:1975](#) Microcopying of technical drawings and other drawing office documents - Part 3: Unitized 35 mm microfilm carriers (ISO Book)
- ISO/DIS 3272-3 Microfilming of technical drawings and other drawing office documents - Part 3: Unitized aperture card for 35 mm microfilm
- [ISO 3272-4:1994](#) Microfilming of technical drawings and other drawing office documents - Part 4: Microfilming of drawings of special and exceptional elongated sizes (ISO Book)
- ISO/FDIS 3272-5 Microfilming of technical drawings and other drawing office documents - Part 5: Test procedures for diazo duplicating of microfilm images in aperture cards
- ISO/DIS 3272-6 Microfilming of technical drawings and other drawing office documents - Part 6: Enlargement from 35 mm microfilm, quality criteria and control
- Symbolic representation - Part 4: Basic symbols for process computer, interface, and shared display/control functions.
- [ISO 5455:1979](#) Technical drawings – Scales. (ISO Book)
- [ISO 5456-1:1996](#) Technical drawings - Projection methods - Part 1: Synopsis (ISO Book)

[ISO 5456-2:1996](#) Technical drawings - Projection methods - Part 2: Orthographic representations (ISO Book)

[ISO 5456-3:1996](#) Technical drawings - Projection methods - Part 3: Axonometric representations

ISO 5456-4:1996 Technical drawings - Projection methods - Part 4: Central projection

[ISO 5457:1999](#) Technical product documentation - Sizes and layout of drawing sheets (Disponível edição 1980). (ISO Book)

[ISO 5845-1:1995](#) Technical drawings - Simplified representation of the assembly of parts with fasteners - Part 1: General principles (ISO Book)

[ISO 5845-2:1995](#) Technical drawings - Simplified representation of the assembly of parts with fasteners - Part 2: Rivets for aerospace equipment (ISO Book)

[ISO 6410-1:1993](#) Technical drawings - Screw threads and threaded parts - Part 1: General conventions (ISO Book)

[ISO 6410-2:1993](#) Technical drawings - Screw threads and threaded parts - Part 2: Screw thread inserts (ISO Book)

[ISO 6410-3:1993](#) Technical drawings - Screw threads and threaded parts - Part 3: Simplified representation (ISO Book)

[ISO 6411:1982](#) Technical drawings - Simplified representation of centre holes (ISO Book)

[ISO 6412-1:1989](#) Technical drawings - Simplified representation of pipelines - Part 1: General rules and orthogonal representation (ISO Book)

[ISO 6412-2:1989](#) Technical drawings - Simplified representation of pipelines - Part 2: Isometric projection (ISO Book)

[ISO 6412-3:1993](#) Technical drawings - Simplified representation of pipelines - Part 3: Terminal features of ventilation and drainage systems (ISO Book)

[ISO 6413:1988](#) Technical drawings - Representation of splines and serrations. (ISO Book)

[ISO 6428:1982](#) Technical drawings - Requirements for microcopying (ISO Book)

[ISO 6433:1981](#) Technical drawings - Item references (ISO Book)

[ISO 7200:1984](#) Technical drawings - Title blocks (ISO Book)

ISO/DIS 7200-1 Technical product documentation - Document headers and title blocks - Part 1: General structure and content

ISO/DIS 7200-2 Technical product documentation - Document headers and title blocks - Part 2: Title blocks for mechanical engineering

[ISO 7573:1983](#) Technical drawings - Item lists (ISO Book)

ISO/TR 8545:1984 Technical drawings -Installations - Graphical symbols for automatic control

[ISO 9222-1:1989](#) Technical drawings - Seals for dynamic application - Part 1: General simplified representation (ISO Book)

[ISO 9222-2:1989](#) Technical drawings - Seals for dynamic application - Part 2: Detailed simplified representation (ISO Book)

[ISO 10135:1994](#) Technical drawings - Simplified representation of moulded, cast and forged parts (ISO Book)

ISO/WD 10135 Technical drawings -- Simplified representation of moulded, cast and forged parts (Ed. 2)

ISO 10303-101:1994 Industrial automation systems and integration - Product data representation and exchange - Part 101: Integrated application resources: Draughting

ISO 10303-201:1994 Industrial automation systems and integration - Product data representation and exchange - Part 201: Application protocol: Explicit draughting

ISO 10303-202:1996 Industrial automation systems and integration - Product data representation and exchange - Part 202: Application protocol: Associative draughting

ISO/TR 10623:1991 Technical product documentation - Requirements for computer-aided design and draughting - Vocabulary

ISO/DIS 12650 Document imaging applications - Microfilming of achromatic maps on 35 mm microfilm

ISO 12678-1:1996 Refractory products - Measurement of dimensions and external defects of refractory bricks - Part 1: Dimensions and conformity to drawings

ISO 13567-1:1998 Technical product documentation - Organization and naming of layers for CAD - Part 1: Overview and principles

ISO 13567-2:1998 Technical product documentation - Organization and naming of layers for CAD - Part 2: Concepts, format and codes used in construction documentation

[ISO 13715:1994](#) Technical drawings - Corners - Vocabulary and indication on drawings (ISO Book)

ISO/FDIS 13715 Technical drawings -- Edges of undefined shape -- Vocabulary and indication on drawings (Ed. 2)

ISO/DIS 13715 Technical drawings - Edges of undefined shape - Vocabulary and indication on drawings

ISO/DIS 14985 Hard-copy output of engineering drawings - Specification for the structure of control files

ISO 15226:1999 Technical product documentation - Life cycle model and allocation of documents

ISO/DIS 16018 Technical drawings - Numerically controlled draughting machines - Draughting media and tools for vector plotters

NORMAS *ISO* SOBRE TOLERANCIAMENTO DIMENSIONAL

ISO 1:1975 ** Standard reference temperature for industrial length measurements. (** ISO Book *Limits*)

ISO/TTA 1:1994 Advanced technical ceramics -- Unified classification system (available in English only) (Ed. 1, 62 p, R)

ISO/WD 1 Geometrical Product Specifications (GPS) -- Reference temperature for industrial length measurements (Ed. 2)

ISO 286-1:1988 ** ISO system of limits and fits — Part 1: Bases of tolerances, deviations and fits (** ISO Book *Limits*)

ISO 286-2:1988 ** ISO system of limits and fits — Part 2: Tables of standard tolerance grades and limit deviations for holes and shafts (** ISO Book *Limits*)

ISO/AWI 286-1 Geometrical product specifications (GPS) -- ISO system of limits and fits -- Part 1: Bases of tolerances, deviations and fits (Ed. 2)

ISO 370:1975 ** Toleranced dimensions — Conversion from inches into millimeters and vice versa (** ISO Book *Limits*)

ISO 406:1987 Technical drawings - Tolerancing of linear and angular dimensions (ISO Book)

ISO 1119:1998 Geometrical Product Specifications (GPS) — Series of conical tapers and taper angles (** ISO Book *Limits*)

ISO 1660:1987 Technical drawings - Dimensioning and tolerancing of profiles (ISO Book)

ISO/AWI 1660 Geometrical Product Specifications (GPS) -- Dimensioning and tolerancing of profiles (*Ed. 3*)

ISO 1829:1975 ** Selection of tolerance zones for general purposes (** ISO Book *Limits*)

ISO/R 1938:1971 ** ISO system of limits and fits — Part II: Inspection of plain workpieces (** ISO Book *Limits*)

ISO 2538:1998 ** Geometrical Product Specifications (GPS) — Series of angles and slopes on prisms (** ISO Book *Limits*)

[ISO 2768-1:1989](#) ** General tolerances — Part 1: Tolerances for linear and angular dimensions without individual tolerance indications (** ISO Book *Limits*)

[ISO 2768-2:1989](#) ** General tolerances — Part 2: Geometrical tolerances for features without individual tolerance indications (** ISO Book *Limits*)

[ISO 3040:1990](#) Technical drawings - Dimensioning and tolerancing - Cones (ISO Book)

[ISO 8062:1994](#) ** Castings — System of dimensional tolerances and machining allowances (** ISO Book *Limits*)

[ISO 13920:1996](#) ** Welding — General tolerances for welded constructions — Dimensions for lengths and angles — Shape and position (** ISO Book *Limits*)

[ISO/TR 14638:1995](#) ** Geometrical product specification (GPS) — Masterplan (** ISO Book *Limits*)

NORMAS *ISO* SOBRE TOLERANCIAMENTO DIMENSIONAL DE PEÇAS ROSCADAS

[ISO 7-1:1994](#) ** Pipe threads where pressure-tight joints are made on the threads — Part 1: Dimensions, tolerances and designation (** ISO Book *Limits*)

[ISO 7-2:1982](#) ** Pipe threads where pressure-tight joints are made on the threads — Part 2: Verification by means of limit gauges (** ISO Book *Limits*)

[ISO 228-1:1994](#) ** Pipe threads where pressure-tight joints are not made on the threads — Part 1: Dimensions, tolerances and designation (** ISO Book *Limits*)

[ISO 228-2:1987](#) ** Pipe threads where pressure-tight joints are not made on the threads — Part 2: Verification by means of limit gauges (** ISO Book *Limits*)

[ISO 965-1:1980](#) ** ISO general purpose metric screw threads — Tolerances — Part 1: Principles and basic data (** ISO Book *Limits*)

[ISO 965-2:1980](#) ** ISO general purpose metric screw threads — Tolerances — Part 2: Limits of sizes for general purpose bolt and nut threads — Medium quality (** ISO Book *Limits*)

[ISO 965-3:1980](#) ** ISO general purpose metric screw threads — Tolerances — Part 3: Deviations for constructional threads (** ISO Book *Limits*)

[ISO/R 1501:1970](#) ** ISO miniature screw threads (** ISO Book *Limits*)

[ISO 1502:1996](#) ** ISO general-purpose metric screw threads — Gauges and gauging (** ISO Book *Limits*)

[ISO 2903:1993](#) ** ISO metric trapezoidal screw threads — Tolerances (** ISO Book *Limits*)

[ISO 5864:1993](#) ** ISO inch screw threads — Allowances and tolerances (** ISO Book *Limits*)

NORMAS **ISO** SOBRE TOLERANCIAMENTO DIMENSIONAL DE ENGRENAGENS

[ISO 1328-1:1995](#) ** Cylindrical gears — ISO system of accuracy — Part 1: Definitions and allowable values of deviations relevant to corresponding flanks of gear teeth (** ISO Book *Limits*)

[ISO 1328-2:1997](#) ** Cylindrical gears — ISO system of accuracy — Part 2: Definitions and allowable values of deviations relevant to radial composite deviations and runout information (** ISO Book *Limits*)

[ISO 4156:1981](#) ** Straight cylindrical involute splines — Metric module, side fit — Generalities, dimensions and inspection (** ISO Book *Limits*)

[ISO 4156:1981 /Amd.1:1992](#) ** Amendment 1:1992 to ISO 4156:1981 Section three: Inspection

[ISO 4468:1982](#) ** Gear hobs — Single start — Accuracy requirements (** ISO Book *Limits*)

NORMAS **ISO** SOBRE TOLERANCIAMENTO GEOMÉTRICO

[ISO 1101:1983](#) Technical drawings -Geometrical tolerancing - Tolerancing of form, orientation, location and run-out -Generalities, definitions, symbols, indications on drawings (ISO Book)

ISO/FDIS 1101 Geometrical product specifications (GPS) -- Geometrical tolerancing -- Tolerances of form, orientation, location and run-out (Ed. 2)

ISO 1101:1983/ Ext 1:1983 Toleranced characteristics and symbols -- Examples of indication and interpretation (Ed. 1, A)

[ISO 2692:1988](#) Technical drawings - Geometrical tolerancing - Maximum material principle (ISO Book)

[ISO 2692:1988 Amd 1:1992](#) Least Material Requirement (ISO Book)

ISO/CD 2692 Technical drawings -- Geometrical tolerancing -- Maximum material principle (Ed. 2)

[ISO 5458:1998](#) Geometrical Product Specifications (GPS) - Geometrical tolerancing - Positional tolerancing (Disponível edição 1987). (ISO Book)

[ISO 5459:1981](#) Technical drawings - Geometrical tolerancing - Datums and datum-systems for geometrical tolerances (ISO Book)

ISO/CD 5459-1 Geometrical Products Specifications (GPS) -- Datums for geometrical tolerancing -- Part 1: General terms and definitions (Ed. 1)

ISO/CD 5459-2 Geometrical Products Specifications (GPS) -- Datums for geometrical tolerancing -- Part 2: Datums and datum systems, drawing indications (Ed. 1)

ISO/WD 5459-3 Geometrical Products Specifications (GPS) -- Datums for geometrical tolerancing -- Part 3: Method for the establishment of datums for the assessment of geometrical tolerances (Ed. 1)

[ISO/TR 5460:1985](#) Technical drawings - Geometrical tolerancing - Tolerancing of form, orientation, location and run-out - Verification principles and methods - Guidelines (ISO Book)

[ISO 7083:1983](#) Technical drawings - Symbols for geometrical tolerancing - Proportions and dimensions (ISO Book)

[ISO 8015:1985](#) Technical drawings - Fundamental tolerancing principle (ISO Book)

[ISO 10578:1992](#) Technical drawings - Tolerancing of orientation and location - Projected tolerance zone (ISO Book)

[ISO 10579:1993](#) Technical drawings - Dimensioning and tolerancing - Non-rigid parts (ISO Book)

NORMAS *ISO* SOBRE SOLDADURA

[ISO 2553:1992](#) Welded, brazed and soldered joints - Symbolic representation on drawings (ISO Book)

ISO/AWI 2553 Welded, brazed and soldered joints -- Symbolic representation on drawings (Ed. 4)

[ISO 4063:1998](#) Welding and allied processes - Nomenclature of processes and reference numbers (Disponível edição 1990). (ISO Book)

NORMAS **ISO** SOBRE ACABAMENTOS SUPERFICIAIS E ESTADOS DE SUPERFÍCIE

ISO 468 - ??? Não existe !

ISO 3274:1996 ** Geometrical Product Specifications (GPS) — Surface texture: Profile method — Nominal characteristics of contact (stylus) instruments (Incorporates the changes made by Technical Corrigendum 1:1998 to ISO 3274:1996) (** ISO Book *Limits*)

ISO 4287:1997 ** Geometrical Product Specifications (GPS) — Surface texture: Profile method — Terms, definitions and surface texture parameters (Incorporates the changes made by Technical Corrigendum 1:1998 to ISO 4287:1997) (** ISO Book *Limits*)

ISO 4288:1996 ** Geometrical Product Specifications (GPS) — Surface texture: Profile method — Rules and procedures for the assessment of surface texture (Incorporates the changes made by Technical Corrigendum 1:1998 to ISO 4288:1996) (** ISO Book *Limits*)

ISO 4291:1985 ** Methods for the assesement of departure from roundness — Measurement of variations in radius (** ISO Book *Limits*)

ISO 4292:1985 ** Methods for the assessment of departure from roundness — Measurement by two- and three-point methods (** ISO Book *Limits*)

ISO 5436:1985 ** Calibration specimens — Stylus instruments — Types, calibration and use of specimens (** ISO Book *Limits*)

ISO 6318:1985 ** Measurement of roundness — Terms, definitions and parameters of roundness (** ISO Book *Limits*)

ISO 8785:1998 ** Geometrical Product Specification (GPS) — Surface imperfections — Terms, definitions and parameters (** ISO Book *Limits*)

ISO 11562:1996 ** Geometrical Product Specifications (GPS) — Surface texture: Profile method — Metrological characteristics of phase correct filters (Incorporates the changes made by Technical Corrigendum 1:1998 to ISO 11562:1996) (** ISO Book *Limits*)

ISO 12085:1996 ** Geometrical Product Specification (GPS) — Surface texture: Profile method — Motif parameters (Incorporates the changes made by Technical Corrigendum 1:1998 to ISO 12085:1996) (** ISO Book *Limits*)

ISO 13565-1:1996 ** Geometrical Product Specification (GPS) — Surface texture: Profile method; Surfaces having stratified functional properties — Part 1: Filtering and general measurement conditions (Incorporates the changes made by Technical Corrigendum 1:1998 to ISO 13565-1:1996) (** ISO Book *Limits*)

ISO 13565-2:1996 **. Geometrical Product Specification (GPS) — Surface texture: Profile method; Surfaces having stratified functional properties — Part 2: Height characterization using the linear material ratio curve (Incorporates the changes made by Technical Corrigendum 1:1998 to ISO 13565-2:1996) (** ISO Book *Limits*)

NORMAS *ISO* SOBRE PEÇAS ROSCADAS

- ISO 68-1:1998 ISO general purpose screw threads -- Basic profile -- Part 1: Metric screw threads
- ISO 68-2:1998 ISO general-purpose screw threads -- Basic profile -- Part 2: Inch screw threads
- ISO 225:1983 Fasteners - Bolts, screws, studs and nuts - Symbols and designations of dimensions
- ISO 261:1998 ISO general-purpose metric screw threads -- General plan
- ISO 262:1998 ISO general-purpose metric screw threads - Selected sizes for screws, bolts and nuts
- ISO 263:1973 ISO inch screw threads - General plan and selection for screws, bolts and nuts - Diameter range 0.06 to 6 in
- ISO 272:1982 Fasteners - Hexagon products - Widths across flats
- ISO 273:1979 Fasteners - Clearance holes for bolts and screws
- ISO 299:1987 Machine tool tables - T-slots and corresponding bolts
- ISO 691:1997 Assembly tools for screws and nuts - Wrench and socket openings - Tolerances for general use
- ISO 724:1993 ISO general-purpose metric screw threads -- Basic dimensions (Ed. 2, 7 p, D)
- ISO 885:1976 General purpose bolts and screws - Metric series - Radii under the head
- ISO 888:1976 Bolts, screws and studs - Nominal lengths, and thread lengths for general purpose bolts
- ISO 898-1:1988 Mechanical properties of fasteners - Part 1: Bolts, screws and studs
- ISO/DIS 898-1 Mechanical properties of fasteners made of carbon steel and alloy steel - Part 1: Bolts, screws and studs
- ISO 898-2:1992 Mechanical properties of fasteners - Part 2: Nuts with specified proof load values - Coarse thread

- ISO 898-5:1998 Mechanical properties of fasteners made of carbon steel and alloy steel - Part 5: Set screws and similar threaded fasteners not under tensile stresses
- ISO 898-6:1994 Mechanical properties of fasteners - Part 6: Nuts with specified proof load values - Fine pitch thread
- ISO 898-7:1992 Mechanical properties of fasteners - Part 7: Torsional test and minimum torques for bolts and screws with nominal diameters 1 mm to 10 mm
- ISO 965-1:1998 ISO general-purpose metric screw threads -- Tolerances -- Part 1: Principles and basic data (Ed. 3, 18 p, J)
- ISO 965-2:1998 ISO general purpose metric screw threads -- Tolerances -- Part 2: Limits of sizes for general purpose external and internal screw threads -- Medium quality (Ed. 3, 5 p, C)
- ISO 965-3:1998 ISO general purpose metric screw threads -- Tolerances -- Part 3: Deviations for constructional screw threads (Ed. 3, 16 p, H)
- ISO 965-4:1998 ISO general purpose metric screw threads -- Tolerances -- Part 4: Limits of sizes for hot-dip galvanized external screw threads to mate with internal screw threads tapped with tolerance position H or G after galvanizing (Ed. 1, 4 p, B)
- ISO 965-5:1998 ISO general purpose metric screw threads -- Tolerances -- Part 5: Limits of sizes for internal screw threads to mate with hot-dip galvanized external screw threads with maximum size of tolerance position h before galvanizing (Ed. 1, 5 p, C)
- ISO 1085:1986 Assembly tools for screws and nuts - Double-ended wrenches - Size pairing
- ISO 1207:1992 Slotted cheese head screws - Product grade A
- ISO 1234:1997 Split pins (Ed. 2, 4 p, B) (Pinos De Imobilização)
- ISO 1478:1983 Tapping screws thread
- ISO/DIS 1478 Tapping screw thread
- ISO 1479:1983 Hexagon head tapping screws
- ISO 1481:1983 Slotted pan head tapping screws
- ISO 1482:1983 Slotted countersunk (flat) head tapping screws (common head style)
- ISO 1483:1983 Slotted raised countersunk (oval) head tapping screws (common head style)
- ISO 1580:1994 Slotted pan head screws - Product grade A
- ISO 1703:1983 Assembly tools for screws and nuts - Nomenclature
- ISO 1711-1:1996 Assembly tools for screws and nuts - Technical specifications - Part 1: Hand-operated wrenches and sockets
- ISO 1891:1979 Bolts, screws, nuts and accessories - Terminology and nomenclature
- ISO 2009:1994 Slotted countersunk flat head screws (common head style) - Product grade A

- ISO 2010:1994 Countersunk slotted raised head screws (common head style) - Product grade A
- ISO 2342:1972 Slotted headless screws - Metric series
- ISO 2351:1986 Screwdriver bits for slotted head screws, with male hexagon drive
- ISO 3266:1984 Eyebolts for general lifting purposes
- ISO 3269:1988 Fasteners - Acceptance inspection
- ISO/DIS 3269 Fasteners - Acceptance inspection
- ISO 3408-1:1991 Ball screws - Part 1: Vocabulary and designation
- ISO 3408-2:1991 Ball screws - Part 2: Nominal diameters and nominal leads - Metric series
- ISO 3408-3:1992 Ball screws - Part 3: Acceptance conditions and acceptance tests
- ISO/DIS 3408-4 Ball screws - Part 4: Axial rigidity
- ISO/DIS 3408-5 Ball screws - Part 5: Static and dynamic axial load ratings and operational lifetime
- ISO 3506-1:1997 Mechanical properties of corrosion-resistant stainless-steel fasteners - Part 1: Bolts, screws and studs
- ISO 3506-2:1997 Mechanical properties of corrosion-resistant stainless-steel fasteners - Part 2: Nuts
- ISO 3506-3:1997 Mechanical properties of corrosion-resistant stainless steel fasteners - Part 3: Set screws and similar fasteners not under tensile stress
- ISO 3508:1976 Thread run-outs for fasteners with thread in accordance with ISO 261 and ISO 262
- ISO 4014:1988 Hexagon head bolts - Product grades A and B
- ISO/DIS 4014 Hexagon head bolts - Product grades A and B
- ISO 4015:1979 Hexagon head bolts - Product grade B - Reduced shank (shank diameter approximately equal to pitch diameter)
- ISO 4016:1988 Hexagon head bolts - Product grade C
- ISO/DIS 4016 Hexagon head bolts - Product grade C
- ISO 4017:1988 Hexagon head screws - Product grades A and B
- ISO/DIS 4017 Hexagon head screws - Product grades A and B
- ISO 4018:1988 Hexagon head screws - Product grade C
- ISO/DIS 4018 Hexagon head screws - Product grade C
- ISO 4026:1993 Hexagon socket set screws with flat point
- ISO 4027:1993 Hexagon socket set screws with cone point
- ISO 4028:1993 Hexagon socket set screws with dog point

- ISO 4029:1993 Hexagon socket set screws with cup point
- ISO 4032:1986 Hexagon nuts, style 1 - Product grades A and B
- ISO/DIS 4032 Hexagon nuts, style 1 - Product grades A and B
- ISO 4033:1979 Hexagon nuts, style 2 - Product grades A and B
- ISO/DIS 4033 Hexagon nuts, style 2 - Product grades A and B
- ISO 4034:1986 Hexagon nuts - Product grade C
- ISO/DIS 4034 Hexagon nuts - Product grade C
- ISO 4035:1986 Hexagon thin nuts (chamfered) - Product grades A and B
- ISO/DIS 4035 Hexagon thin nuts (chamfered) - Product grades A and B
- ISO 4036:1979 Hexagon thin nuts - Product grade B (unchamfered)
- ISO/DIS 4036 Hexagon thin nuts (unchamfered) - Product grade B
- ISO 4161:1999 Hexagon nuts with flange - Coarse thread
- ISO 4162:1990 Hexagon flange bolts - Small series
- ISO/DIS 4162 Hexagon bolts with flange - Small series - Product grade combination A/B
- ISO 4229:1977 Assembly tools for screws and nuts - Single-head engineer's wrenches - Gaps from 50 to 120 mm
- ISO 4753:1983 Fasteners - Ends of parts with external metric ISO thread
- ISO 4755:1983 Fasteners - Thread undercuts for external metric ISO threads
- ISO 4757:1983 Cross recesses for screws
- ISO 4759-1:1978 Tolerances for fasteners - Part 1: Bolts, screws and nuts with thread diameters between 1,6 (inclusive) and 150 mm (inclusive) and product grades A, B and C
- ISO/DIS 4759-1 Tolerances for fasteners - Part 1: Bolts, screws, studs and nuts - Product grades A, B and C
- ISO 4759-3:1991 Tolerances for fasteners - Part 3: Plain washers for bolts, screws and nuts with nominal thread diameters from 1 mm up to and including 150 mm - Product grades A and C
- ISO/DIS 4759-3 Tolerances for fasteners - Part 3: Plain washers for bolts, screws and nuts - Product grades A and C
- ISO 4762:1997 Hexagon socket head cap screws
- ISO 4766:1983 Slotted set screws with flat point
- ISO 4775:1984 Hexagon nuts for high-strength structural bolting with large width across flats - Product grade B - Property classes 8 and 10

- ISO/DIS 4775 Hexagon nuts for high-strength structural bolting with large width across flats - Product grade B - Property classes 8 and 10 (Revision of ISO 4775:1984)
- ISO 7045:1994 Pan head screws with type H or type Z cross recess - Product grade A
- ISO 7046-1:1994 Countersunk flat head screws (common head style) with type H or type Z cross recess - Product grade A - Part 1: Steel of property class 4.8
- ISO 7046-2:1990 Cross-recessed countersunk flat head screws (common head style) - Grade A - Part 2: Steel of property class 8.8, stainless steel and non-ferrous metals
- ISO 7047:1994 Countersunk raised head screws (common head style) with type H or type Z cross recess - Product grade A
- ISO 7048:1998 Cross recessed cheese head screws
- ISO 7049:1983 Cross recessed pan head tapping screws
- ISO 7050:1983 Cross recessed countersunk (flat) head tapping screws (common head style)
- ISO 7051:1983 Cross recessed raised countersunk (oval) head tapping screws
- ISO 7053:1992 Hexagon washer head tapping screws
- ISO 7378:1983 Fasteners - Bolts, screws and studs - Split pin holes and wire holes
- ISO 7379:1983 Hexagon socket head shoulder screws
- ISO 7380:1997 Hexagon socket button head screws
- ISO 7411:1984 Hexagon bolts for high-strength structural bolting with large width across flats (thread lengths according to ISO 888) - Product grade C - Property classes 8.8 and 10.9
- ISO/DIS 7411 Hexagon bolts for high-strength structural bolting with large width across flats (thread lengths according to ISO 888) - Product grade C - Property classes 8.8 and 10.9 (Revision of ISO 7411:1984)
- ISO 7412:1984 Hexagon bolts for high-strength structural bolting with large width across flats (short thread length) - Product grade C - Property classes 8.8 and 10.9
- ISO/DIS 7412 Hexagon bolts for high-strength structural bolting with large width across flats (short thread length) - Product grade C - Property classes 8.8 and 10.9 (Revision of ISO 7412:1984)
- ISO 7413:1984 Hexagon nuts for structural bolting, style 1, hot-dip galvanized (oversize tapped) - Product grades A and B - Property classes 5, 6 and 8
- ISO/DIS 7413 Hexagon nuts for structural bolting, style 1, hot-dip galvanized (oversize tapped) - Product grades A and B - Property classes 5, 6 and 8 (Revision of ISO 7413:1984)

- ISO 7414:1984 Hexagon nuts for structural bolting with large width across flats, style 1 - Product grade B - Property class 10
- ISO/DIS 7414 Hexagon nuts for structural bolting with large width across flats, style 1 - Product grade B - Property class 10 (Revision of ISO 7414:1984)
- ISO 7417:1984 Hexagon nuts for structural bolting - Style 2, hot-dip galvanized (oversize tapped) - Product grade A - Property class 9
- ISO/DIS 7417 Hexagon nuts for structural bolting, style 2, hot-dip galvanized (oversize tapped) - Product grade A - Property class 9 (Revision of ISO 7417:1984)
- ISO 7434:1983 Slotted set screws with cone point
- ISO 7435:1983 Slotted set screws with long dog point
- ISO 7436:1983 Slotted set screws with cup point
- ISO 8673:1988 Hexagon nuts, style 1, with metric fine pitch thread - Product grades A and B
- ISO/DIS 8673 Hexagon nuts, style 1, with metric fine pitch thread - Product grades A and B
- ISO 8674:1988 Hexagon nuts, style 2, with metric fine pitch thread - Product grades A and B
- ISO/DIS 8674 Hexagon nuts, style 2, with metric fine pitch thread - Product grades A and B
- ISO 8675:1988 Hexagon thin nuts with metric fine pitch thread - Product grades A and B
- ISO/DIS 8675 Hexagon thin nuts (chamfered) with metric fine pitch thread - Product grades A and B
- ISO 8676:1988 Hexagon head screws with metric fine pitch thread - Product grades A and B
- ISO/DIS 8676 Hexagon head screws with metric fine pitch thread - Product grades A and B
- ISO 8677:1986 Cup head square neck bolts with large head - Product grade C
- ISO 8678:1988 Cup head square neck bolts with small head and short neck - Product grade B
- ISO 8765:1988 Hexagon head bolts with metric fine pitch thread - Product grades A and B
- ISO/DIS 8765 Hexagon head bolts with metric fine pitch thread - Product grades A and B
- ISO 10663:1999 Hexagon nuts with flange - Fine pitch thread
- ISO/DIS 10664 Hexalobular internal driving feature for bolts and screws
- ISO/DIS 10666 Drilling screws with tapping screw thread - Mechanical and functional properties
- ISO 10897:1996 Collets for tool holders with taper ratio 1:10 - Collets, holders, nuts
- ISO 15071:1999 Hexagon bolts with flange - Small series - Product grade A
- ISO/DIS 15072 Hexagon bolts with flange with metric fine pitch thread - Small series - Product grade A
- ISO/DIS 15073 Hexagon bolts with flange with metric fine pitch thread - Small series - Product grade combination A/B

- ISO/DIS 15480 Hexagon washer head drilling screws with tapping screw thread
- ISO/DIS 15481 Cross recessed pan head drilling screws with tapping screw thread
- ISO/DIS 15482 Cross recessed countersunk head drilling screws with tapping screw thread
- ISO/DIS 15483 Cross recessed raised countersunk head drilling screws with tapping screw thread
- ISO 15488:1996 Collets with 8 degree setting angle for tool shanks - Collets, nuts and fitting dimensions

NORMAS *ISO* SOBRE ANILHAS

- ISO 887:1983 Plain washers for metric bolts, screws and nuts - General plan
- ISO/DIS 887 Plain washers for metric bolts, screws and nuts for general purposes - General plan
- ISO 7089:1983 Plain washers -- Normal series -- Product grade A (Ed. 1, 3 p, B)
- ISO/FDIS 7089 Plain washers -- Normal series -- Product grade A (Ed. 2)
- ISO 7091:1983 Plain washers -- Normal series -- Product grade C (Ed. 1, 3 p, B)
- ISO/FDIS 7091 Plain washers -- Normal series -- Product grade C (Ed. 2)
- ISO 7092:1983 Plain washers -- Small series -- Product grade A (Ed. 1, 3 p, B)
- ISO/FDIS 7092 Plain washers -- Small series -- Product grade A (Ed. 2)
- ISO 7093:1983 Plain washers -- Large series -- Product grades A and C (Ed. 1, 3 p, B)
- ISO/FDIS 7093-1 Plain washers -- Large series -- Part 1: Product grade A (Ed. 1)
- ISO/FDIS 7093-2 Plain washers -- Large series -- Part 2: Product grade C (Ed. 1)
- ISO 7094:1983 Plain washers -- Extra large series -- Product grade C (Ed. 1, 2 p, A)
- ISO/FDIS 7094 Plain washers -- Extra large series -- Product grade C (Ed. 2)
- ISO 7415:1984 Plain washers for high-strength structural bolting, hardened and tempered (Ed. 1, 2 p, A)
- ISO 8738:1986 Plain washers for clevis pins -- Product grade A (Ed. 1, 3 p, B)
- ISO 10669:1999 Plain washers for tapping screw and washer assemblies -- Normal and large series -- Product grade A (Ed. 1, 4 p, B)
- ISO 10673:1998 Plain washers for screw and washer assemblies -- Small, normal and large series -- Product grade A (Ed. 1, 5 p, C)

NORMAS *ISO* SOBRE MOLAS

[ISO 2162-1:1993](#) Technical product documentation - Springs - Part 1: Simplified representation (ISO Book)

[ISO 2162-2:1993](#) Technical product documentation - Springs - Part 2: Presentation of data for cylindrical helical compression springs (ISO Book)

[ISO 2162-3:1993](#) Technical product documentation - Springs - Part 3: Vocabulary (ISO Book)

ISO 6931-1:1994 Stainless steels for springs -- Part 1: Wire (Ed. 2, 11 p, F)

ISO 6931-2:1989 Stainless steels for springs -- Part 2: Strip (Ed. 1, 8 p, D)

ISO 8458-1:1989 Steel wire for mechanical springs -- Part 1: General requirements (Ed. 1, 3 p, B)

ISO/CD 8458-1 Steel wire for mechanical springs -- Part 1: General requirements (Ed. 2)

ISO 8458-2:1989 Steel wire for mechanical springs -- Part 2: Cold-drawn carbon steel wire (Ed. 1, 5 p, C)

ISO/CD 8458-2 Steel wire for mechanical springs -- Part 2: Patented cold-drawn unalloyed steel wire (Ed. 2)

ISO 8458-3:1992 Steel wire for mechanical springs -- Part 3: Oil-hardened and tempered wire (Ed. 1, 7 p, D)

ISO/CD 8458-3 Steel wire for mechanical springs -- Part 3: Oil-hardened and tempered wire (Ed. 2)

NORMAS *ISO* SOBRE ROLAMENTOS

[ISO 8826-1:1989](#) Technical drawings - Rolling bearings - Part 1: General simplified representation (ISO Book)

[ISO 8826-2:1994](#) Technical drawings - Rolling bearings - Part 2: Detailed simplified representation (ISO Book)

NORMAS *ISO* SOBRE ENGRENAGENS

ISO 54:1996 Cylindrical gears for general engineering and for heavy engineering -- Modules (Ed. 2, 2 p, A)

[ISO 2203:1973](#) Technical drawings - Conventional representation of gears (ISO Book)

NORMAS *ISO* SOBRE *CONSTRUCTION DRAWINGS*

- [ISO 3766:1995](#) Construction drawings - Simplified representation of concrete reinforcement
- [ISO 4066:1994](#) Construction drawings - Bar scheduling (ISO Book)
- [ISO 4068:1978](#) Building and civil engineering drawings - Reference lines (ISO Book)
- [ISO 4069:1977](#) Building and civil engineering drawings - Representation of areas on sections and views - General principles (ISO Book)
- [ISO 4157-1:1998](#) Construction drawings - Designation systems - Part 1: Buildings and parts of buildings (Disponível edição 1980). (ISO Book)
- [ISO 4157-2:1998](#) Construction drawings - Designation systems - Part 2: Room names and numbers (Disponível edição 1982). (ISO Book)
- ISO 4157-3:1998 Construction drawings - Designation systems - Part 3: Room identifiers
- [ISO 4172:1991](#) Technical drawings - Construction drawings - Drawings for the assembly of prefabricated structures. (ISO Book)
- [ISO 5261:1995](#) Technical drawings - Simplified representation of bars and profile sections (ISO Book)
- [ISO 6284:1996](#) Construction drawings - Indication of limit deviations (ISO Book)
- [ISO/TR 7084:1981](#) Technical drawings - Coding and referencing systems for building and civil engineering drawings and associated documents (ISO Book)
- [ISO 7437:1990](#) Technical drawings - Construction drawings - General rules for execution of production drawings for prefabricated structural components (ISO Book)
- [ISO 7518:1983](#) Technical drawings - Construction drawings - Simplified representation of demolition and rebuilding (ISO Book)
- [ISO 7519:1991](#) Technical drawings - Construction drawings - General principles of presentation for general arrangement and assembly drawings (ISO Book)
- [ISO 8048:1984](#) Technical drawings - Construction drawings - Representation of views, sections and cuts (ISO Book)
- [ISO 8560:1986](#) Technical drawings - Construction drawings - Representation of modular sizes, lines and grids (ISO Book)
- [ISO 9431:1990](#) Construction drawings - Spaces for drawing and for text, and title blocks on drawing sheets (ISO Book)
- [ISO/TR 10127:1990](#) Computer-Aided Design (CAD) Technique - Use of computers for the preparation of construction drawings (ISO Book)
- [ISO 11091:1994](#) Construction drawings - Landscape drawing practice (ISO Book)

NORMAS **ISO** SOBRE PRODUTOS ESPECÍFICOS E INDIRECTAMENTE RELACIONADAS COM O DESENHO TÉCNICO

[ISO 6414:1982](#) Technical drawings for glassware (ISO Book)

[ISO 10110-1:1996](#) Optics and optical instruments - Preparation of drawings for optical elements and systems - Part 1: General (ISO Book)

[ISO 10110-2:1996](#) Optics and optical instruments - Preparation of drawings for optical elements and systems - Part 2: Material imperfections - Stress birefringence (ISO Book)

[ISO 10110-3:1996](#) Optics and optical instruments - Preparation of drawings for optical elements and systems - Part 3: Material imperfections - Bubbles and inclusions (ISO Book)

[ISO 10110-4:1997](#) Optics and optical instruments - Preparation of drawings for optical elements and systems - Part 4: Material imperfections - Inhomogeneity and striae (ISO Book)

[ISO 10110-5:1996](#) Optics and optical instruments - Preparation of drawings for optical elements and systems - Part 5: Surface form tolerances (ISO Book)

[ISO 10110-6:1996](#) Optics and optical instruments - Preparation of drawings for optical elements and systems - Part 6: Centring tolerances (ISO Book)

[ISO 10110-7:1996](#) Optics and optical instruments - Preparation of drawings for optical elements and systems - Part 7: Surface imperfection tolerances (ISO Book)

ISO 10110-8:1997 Optics and optical instruments - Preparation of drawings for optical elements and systems - Part 8: Surface texture

[ISO 10110-9:1996](#) Optics and optical instruments - Preparation of drawings for optical elements and systems - Part 9: Surface treatment and coating (ISO Book)

[ISO 10110-10:1996](#) Optics and optical instruments - Preparation of drawings for optical elements and systems - Part 10: Table representing data of a lens element (ISO Book)

[ISO 10110-11:1996](#) Optics and optical instruments - Preparation of drawings for optical elements and systems - Part 11: Non-toleranced data (ISO Book)

ISO 10110-12:1997 Optics and optical instruments - Preparation of drawings for optical elements and systems - Part 12: Aspheric surfaces

ISO/DIS 10110-14 Optics and optical instruments - Preparation of drawings for optical elements and systems - Part 14: Wavefront deformation tolerance for systems containing zero-power elements only (Formerly ISO/NP 15000)

ISO/DIS 10110-15 Optics and optical instruments -- Preparation of drawings for optical elements and systems -- Part 15: Wavefront deformation tolerance for systems containing powered elements (Ed. 1, 37 p, *)

ISO/AWI 10110-16 Optics and optical instruments -- Preparation of drawings for optical elements and systems -- Part 16: Aspheric diffractive surfaces (Ed. 1)

ISO/CD 10110-17 Optics and optical instruments -- Preparation of drawings for optical elements and systems -- Part 17: Laser irradiation damage threshold (Ed. 1)

NORMAS *ISO* SOBRE SIMBOLOS GRÁFICOS USADOS NOS DESENHOS E EM DOCUMENTAÇÃO TÉCNICA EM GERAL

[ISO/R 538:1967](#) Conventional signs to be used in the schemes for the installations of pipeline systems in ships (ISO Book)

[ISO 561:1989](#) Coal preparation plant -- Graphical symbols (ISO Book)

[ISO 710-1:1974](#) Graphical symbols for use on detailed maps, plans and geological cross-sections -- Part 1: General rules of representation (ISO Book)

[ISO 710-2:1974](#) Graphical symbols for use on detailed maps, plans and geological cross-sections -- Part 2: Representation of sedimentary rocks (ISO Book)

[ISO 710-3:1974](#) Graphical symbols for use on detailed maps, plans and geological cross-sections -- Part 3: Representation of magmatic rocks (ISO Book)

[ISO 710-4:1982](#) Graphical symbols for use on detailed maps, plans and geological cross-sections -- Part 4: Representation of metamorphic rocks (ISO Book)

[ISO 710-5:1989](#) Graphical symbols for use on detailed maps, plans and geological cross-sections -- Part 5: Representation of minerals (ISO Book)

[ISO 710-6:1984](#) Graphical symbols for use on detailed maps, plans and geological cross-sections -- Part 6: Representation of contact rocks and rocks which have undergone metasomatic, pneumatolytic or hydrothermal transformation or transformation by weathering (ISO Book)

[ISO 710-7:1984](#) Graphical symbols for use on detailed maps, plans and geological cross-sections -- Part 7: Tectonic symbols (ISO Book)

[ISO/R 784:1968](#) Conventional signs to be used in schemes for the installations of sanitary systems in ships (ISO Book)

[ISO 1219-1:1991](#) Fluid power systems and components -- Graphic symbols and circuit diagrams -- Part 1: Graphic symbols (ISO Book)

ISO/CD 1219-1 Fluid power systems and components -- Graphic symbols and circuit diagrams -- Part 1: Graphic symbols (ISO Book)

[ISO 1219-2:1995](#) Fluid power systems and components -- Graphic symbols and circuit diagrams -- Part 2: Circuit diagrams (ISO Book)

[ISO 1964:1987](#) Shipbuilding -- Indication of details on the general arrangement plans of ships (ISO Book)

[ISO 3511-1:1977](#) Process measurement control functions and instrumentation -- Symbolic representation -- Part 1: Basic requirements (ISO Book)

[ISO 3511-2:1984](#) Process measurement control functions and instrumentation -- Symbolic representation -- Part 2: Extension of basic requirements (ISO Book)

[ISO 3511-3:1984](#) Process measurement control functions and instrumentation -- Symbolic representation -- Part 3: Detailed symbols for instrument interconnection diagrams (ISO Book)

[ISO 3511-4:1985](#) Industrial process measurement control functions and instrumentation -- Symbolic representation -- Part 4: Basic symbols for process computer, interface, and shared display/control functions (ISO Book)

[ISO 3753:1977](#) Vacuum technology -- Graphical symbols (ISO Book)

[ISO 3952-1:1981](#) Kinematic diagrams -- Graphical symbols (ISO Book)

[ISO 3952-2:1981](#) Kinematic diagrams -- Graphical symbols (ISO Book)

[ISO 3952-3:1979](#) Kinematic diagrams -- Graphical symbols (ISO Book)

[ISO 3952-4:1984](#) Kinematic diagrams -- Graphical symbols (ISO Book)

[ISO 3971:1977](#) Rice milling -- Symbols and equivalent terms (ISO Book)

[ISO 4067-1:1984](#) Technical drawings -- Installations -- Part 1: Graphical symbols for plumbing, heating, ventilation and ducting (ISO Book)

[ISO 4067-2:1980](#) Building and civil engineering drawings -- Installations -- Part 2: Simplified representation of sanitary appliances (ISO Book)

[ISO 4067-6:1985](#) Technical drawings -- Installations -- Part 6: Graphical symbols for supply water and drainage systems in the ground (ISO Book)

[ISO 5232:1998](#) Graphical symbols for textile machinery (ISO Book)

[ISO 5784-1:1988](#) Fluid power systems and components -- Fluid logic circuits -- Part 1: Symbols for binary logic and related functions (ISO Book)

- [ISO 5784-2:1989](#) Fluid power systems and components -- Fluid logic circuits -- Part 2: Symbols for supply and exhausts as related to logic symbols (ISO Book)
- [ISO 5784-3:1989](#) Fluid power systems and components -- Fluid logic circuits -- Part 3: Symbols for logic sequencers and related functions (ISO Book)
- [ISO 5807:1985](#) Information processing -- Documentation symbols and conventions for data, program and system flowcharts, program network charts and system resources charts (ISO Book)
- [ISO 5859:1991](#) Aerospace -- Graphic symbols for schematic drawings of hydraulic and pneumatic systems and components (ISO Book)
- [ISO 6790:1986](#) Equipment for fire protection and fire fighting -- Graphical symbols for fire protection plans – Specification (ISO Book)
- [ISO 6829:1983](#) Flowchart symbols and their use in micrographics (ISO Book)
- [ISO 8790:1987](#) Information processing systems -- Computer system configuration diagram symbols and conventions (ISO Book)
- [ISO 9878:1990](#) Micrographics -- Graphical symbols for use in microfilming (ISO Book)
- [ISO 10628:1997](#) Flow diagrams for process plants -- General rules (ISO Book)

NORMAS *ISO* SOBRE DOCUMENTAÇÃO TÉCNICA DO PRODUTO

- [ISO 10209-1:1992](#) Technical product documentation -- Vocabulary -- Part 1: Terms relating to technical drawings: general and types of drawings (ISO Book)
- [ISO 10209-2:1993](#) Technical product documentation -- Vocabulary -- Part 2: Terms relating to projection methods (ISO Book)
- ISO 10209-4:1999 Technical product documentation -- Vocabulary -- Part 4: Terms relating to construction documentation (Ed. 1, K)
- [ISO 11442-1:1993](#) Technical product documentation -- Handling of computer-based technical information -- Part 1: Security requirements (ISO Book)
- ISO/AWI 11442-1 Technical product documentation -- Handling of computer-based technical information -- Part 1: Security requirements (Ed. 2)
- [ISO 11442-2:1993](#) Technical product documentation -- Handling of computer-based technical information -- Part 2: Original documentation (ISO Book)

ISO/AWI 11442-2 Technical product documentation -- Handling of computer-based technical information -- Part 2: Original documentation (Ed. 2)

[ISO 11442-3:1993](#) Technical product documentation -- Handling of computer-based technical information -- Part 3: Phases in the product design process (ISO Book)

ISO/AWI 11442-3 Technical product documentation -- Handling of computer-based technical information -- Part 3: Phases in the product design process (Ed. 2)

[ISO 11442-4:1993](#) Technical product documentation -- Handling of computer-based technical information -- Part 4: Document management and retrieval systems (ISO Book)

ISO/AWI 11442-4 Technical product documentation -- Handling of computer-based technical information -- Part 4: Document management and retrieval systems (Ed. 2)

ISO 11442-5 Technical product documentation -- Handling of computer-based technical information -- Part 5: Documentation in the conceptual design stage of the development phase (Ed. 1, 3 p)

ISO/DIS 11442-6 Technical product documentation -- Handling of computer-based technical information -- Part 6: Rules for revision (Ed. 1, 4 p)

ISO/DIS 11442-7 Technical product documentation -- Handling of computer-based technical information -- Part 7: Structuring CAD files from an administrative point of view (Ed. 1, 4 p)

ISO/DIS 11442-8 Technical product documentation -- Handling of computer-based technical information -- Part 8: Data fields for title blocks, item lists and revision blocks (Ed. 1, 7 p)

ISO/DIS 11442-9 Technical product documentation -- Handling of computer-based technical information -- Part 9: Terminology (Ed. 1, 6 p)

NORMAS *ISO* SOBRE QUALIDADE

ISO 8402:1994 Quality management and quality assurance -- Vocabulary (Ed. 2, R)

ISO/DIS 9000 Quality management systems -- Fundamentals and vocabulary (Ed. 2)

ISO 9000-1:1994 Quality management and quality assurance standards -- Part 1: Guidelines for selection and use (Ed. 1, 18 p, J)

- ISO 9000-2:1997 Quality management and quality assurance standards -- Part 2: Generic guidelines for the application of ISO 9001, ISO 9002 and ISO 9003 (Ed. 2, 26 p, M)
- ISO 9000-3:1997 Quality management and quality assurance standards -- Part 3: Guidelines for the application of ISO 9001:1994 to the development, supply, installation and maintenance of computer software (Ed. 2, 32 p, P)
- ISO 9000-4:1993 Quality management and quality assurance standards -- Part 4: Guide to dependability programme management (Ed. 1, L)
- ISO 9001:1994 Quality systems -- Model for quality assurance in design, development, production, installation and servicing (Ed. 2, 11 p, F)
- ISO/DIS 9001 Quality management systems -- Requirements (Ed. 3)
- ISO 9001:1994/Cor 1:1995 (available in French only) (Ed. 1, *)
- ISO 9002:1994 Quality systems -- Model for quality assurance in production, installation and servicing (Ed. 2, 10 p, E)
- ISO 9002:1994/Cor 1:1995 (available in French only) (Ed. 1, *)
- ISO 9003:1994 Quality systems -- Model for quality assurance in final inspection and test (Ed. 2, 7 p, D)
- ISO 9003:1994/Cor 1:1994 (available in French only) (Ed. 1, *)
- ISO 9003:1994/Cor 2:1995 (available in French only) (Ed. 1, *)
- ISO/DIS 9004 Quality management systems -- Guidelines for performance improvements (Ed. 2)
- ISO 9004-1:1994 Quality management and quality system elements -- Part 1: Guidelines (Ed. 1, 23 p, L)
- ISO 9004-2:1991 Quality management and quality system elements -- Part 2: Guidelines for services (Ed. 1, 18 p, J)
- ISO 9004-2:1991/Cor 1:1994 (available in French only) (Ed. 1, *)
- ISO 9004-3:1993 Quality management and quality system elements -- Part 3: Guidelines for processed materials (Ed. 1, 21 p, L)
- ISO 9004-4:1993 Quality management and quality system elements -- Part 4: Guidelines for quality improvement (Ed. 1, 25 p, M)
- ISO 9004-4:1993/Cor 1:1994 (Ed. 1, 2 p, *)

NORMAS **ISO** SOBRE EQUIPAMENTO PARA DESENHO

[ISO 9175-1:1988](#) Tubular tips for hand-held technical pens using India ink on tracing paper -- Part 1: Definitions, dimensions, designation and marking (ISO Book)

[ISO 9175-2:1988](#) Tubular tips for hand-held technical pens using India ink on tracing paper -- Part 2: Performance, test parameters and test conditions (ISO Book)

[ISO 9176:1988](#) Tubular technical pens -- Adaptor for compasses (ISO Book)

[ISO 9177-1:1989](#) Mechanical pencils -- Part 1: Classification, dimensions, performance requirements and testing (ISO Book)

[ISO 9177-2:1989](#) Mechanical pencils -- Part 2: Black leads -- Classification and dimensions (ISO Book)

[ISO 9177-3:1994](#) Mechanical pencils -- Part 3: Black leads -- Bending strengths of HB leads (ISO Book)

[ISO 9178-1:1988](#) Templates for lettering and symbols -- Part 1: General principles and identification markings (ISO Book)

[ISO 9178-2:1988](#) Templates for lettering and symbols -- Part 2: Slot widths for wood-cased pencils, clutch pencils and fine-lead pencils (ISO Book)

[ISO 9178-3:1989](#) Templates for lettering and symbols -- Part 3: Slot widths for technical pens with tubular tips in accordance with ISO 9175-1 (ISO Book)

[ISO 9179-1:1988](#) Technical drawings -- Numerically controlled draughting machines -- Part 1: Vocabulary (ISO Book)

[ISO 9180:1988](#) Black leads for wood-cased pencils -- Classification and diameters (ISO Book)

[ISO 9957-1:1992](#) Fluid draughting media -- Part 1: Water-based India ink -- Requirements and test conditions (Ed. 1, 6 p, C)

[ISO 9957-2:1995](#) Fluid draughting media -- Part 2: Water-based non-India ink -- Requirements and test conditions (ISO Book)

ISO 9957-3:1997 Fluid draughting media -- Part 3: Water-based coloured draughting inks -- Requirements and test conditions (Ed. 1, 10 p, E)

[ISO 9958-1:1992](#) Draughting media for technical drawings -- Draughting film with polyester base -- Part 1: Requirements and marking (ISO Book)

[ISO 9958-2:1992](#) Draughting media for technical drawings -- Draughting film with polyester base -- Part 2: Determination of properties (ISO Book)

- [ISO 9959-1:1992](#) Numerically controlled draughting machines -- Drawing test for the evaluation of performance -- Part 1: Vector plotters (ISO Book)
- ISO 9959-2:1999 Numerically controlled draughting machines -- Draughting test for evaluation of performance -- Part 2: Monochrome raster plotters (Ed. 1, 15 p, H)
- [ISO 9960-1:1992](#) Draughting instruments with or without graduation -- Part 1: Draughting scale rules (ISO Book)
- [ISO 9960-2:1994](#) Draughting instruments with or without graduation -- Part 2: Protractors (ISO Book)
- [ISO 9960-3:1994](#) Draughting instruments with or without graduation -- Part 3: Set squares (ISO Book)
- [ISO 9961:1992](#) Draughting media for technical drawings -- Natural tracing paper (ISO Book)
- [ISO 9962-1:1992](#) Manually operated draughting machines -- Part 1: Definitions, classification and designation (ISO Book)
- [ISO 9962-2:1992](#) Manually operated draughting machines -- Part 2: Characteristics, performance, inspection and marking (ISO Book)
- [ISO 9962-3:1994](#) Manually operated draughting machines -- Part 3: Dimensions of scale rule chuck plates (ISO Book)
- [ISO 11540:1993](#) Caps for writing and marking instruments intended for use by children up to 14 years of age -- Safety requirements (ISO Book)

ASPECTOS GERAIS RELACIONADOS COM AS NORMAS ISO

Reference number - This consists of a prefix, a serial number and the year of publication. The prefix will usually be "ISO" to indicate that the publication is an ISO International Standard.

The prefix **ISO/IEC** denotes a joint ISO and IEC (International Electrotechnical Commission) publication. ISO/IEC International Standards are developed by Joint ISO/IEC Technical Committee JTC 1. A few IEC International Standards with the prefix IEC, which belong to JTC 1, have also been included in the Catalogue. Similarly to the ISO/IEC prefix, the **ISO/CIE** prefix denotes a joint ISO and CEI (International Commission on Illumination) International Standard.

The prefix **ISO/TR** or ISO/IEC TR denotes an ISO or ISO/IEC technical report. These reports are published in certain circumstances to provide either interim progress reports or

factual information of a kind different from that normally incorporated in an International Standard.

The prefix **ISO/IEC ISP** denotes an ISO/IEC International Standardized Profile - an internally agreed, harmonized document which identifies a standard or group of standards, together with options and parameters, necessary to perform a function or set of functions.

The prefix **ISO/TTA** denotes an ISO publication named technical trend assessment. These publications were established for responding to the need for global collaboration on standardization at early stages of technological innovations. They are the result of either direct cooperation with pre-standardization organizations or ad hoc workshops of experts concerned with standardization needs and trends in emerging fields.

The prefix **ISO Guide** or **ISO/IEC Guide** denotes ISO or ISO/IEC guides, which are documents of a general nature on matters related to international standardization, such as guidelines, policy statements, model rules or application guides.

The prefix **ISO/R** denotes an ISO recommendation. This designation was used up to 1972, when ISO began to publish International Standards. Since then, ISO recommendations have gradually been revised and republished as International Standards. A limited number of ISO recommendations, for which the revision and transformation into International Standards have not yet been completed, remain available.

The prefix is followed by a serial number which may include a part number, separated by a hyphen from the main number. The serial number is followed by the year of publication separated from the serial number by a colon.

Prefixes containing the abbreviations **DIS**, **DTR** and **DISP** belong respectively to draft International Standards, draft technical reports and draft International Standardized Profiles. An initial F may be used in conjunction with one of the foregoing prefixes to denote a final draft, e.g. **FDIS** indicates a final draft International Standard. Some draft documents, such as draft guides or draft amendments to International Standards, do not take a special prefix or carry the word draft.

All draft documents may be identified by the fact that reference numbers of drafts do not include a year of publication.

LISTA DAS NORMAS POR ORDEM ALFABÉTICA

- EN 20286-1:1993, 7
 EN 20286-2:1993, 7
 EN 20898-1:1991, 6
EN 22553:1994, 8
 EN 22768-1:1993, 7
 EN 22768-2:1993, 7
EN 24014:1991, 8
 EN 24015:1991, 8
 EN 24016:1991, 8
 EN 24017:1991, 8
 EN 24018:1991, 8
EN 24063:1992, 8
 EN 2574:1990, 8
 EN 2851:1992, 6
 EN 28676:1991, 8
 EN 28738:1992, 8
 EN ISO 10644:1998, 8
 EN ISO 10673:1998, 8
EN ISO 2162-1:1996, 9
EN ISO 2162-2:1996, 9
EN ISO 2162-3:1996, 9
EN ISO 2203:1997, 9
 EN ISO 4172:1996, 6
 EN ISO 5455:1994, 6
 EN ISO 5457:1999, 6
 EN ISO 6410-1:1996, 6
 EN ISO 6410-2:1996, 6
 EN ISO 6410-3:1996, 6
 EN ISO 6411:1997, 6
 EN ISO 6412-1:1994, 6
 EN ISO 6412-2:1994, 6
 EN ISO 6412-3:1996, 6
 EN ISO 6413:1994, 6
 EN ISO 6414:1994, 6
 EN ISO 6433:1994, 6
EN ISO 7083:1994, 7
 EN ISO 7437:1996, 7
 EN ISO 7519:1996, 7
EN ISO 8826-1:1995, 9
EN ISO 8826-2:1997, 9
 EN ISO 9222-1:1995, 7
 EN ISO 9222-2:1994, 7
ISO 1:1975, 14
ISO 10110-1:1996, 28
ISO 10110-10:1996, 28
ISO 10110-11:1996, 28
 ISO 10110-12:1997, 28
ISO 10110-2:1996, 28
ISO 10110-3:1996, 28
ISO 10110-4:1997, 28
ISO 10110-5:1996, 28
ISO 10110-6:1996, 28
ISO 10110-7:1996, 28
 ISO 10110-8:1997, 28
ISO 10110-9:1996, 28
ISO 10135:1994, 13
ISO 10209-1:1992, 31
ISO 10209-2:1993, 31
 ISO 10209-4:1999, 31
 ISO 10303-101:1994, 13
 ISO 10303-201:1994, 13
 ISO 10303-202:1996, 13
ISO 10578:1992, 17
ISO 10579:1993, 17
ISO 10628:1997, 31
 ISO 10663:1999, 24
 ISO 10669:1999, 25
 ISO 10673:1998, 25
 ISO 1085:1986, 20
 ISO 10897:1996, 24
ISO 1101:1983, 16
 ISO 1101:1983/ Ext 1:1983, 16
ISO 11091:1994, 27
ISO 1119:1998, 14
ISO 11442-1:1993, 31
ISO 11442-2:1993, 31
ISO 11442-3:1993, 32
ISO 11442-4:1993, 32
 ISO 11442-5, 32
ISO 11540:1993, 35
ISO 11562:1996, 18
 ISO 1207:1992, 20
ISO 12085:1996, 18
ISO 1219-1:1991, 30
ISO 1219-2:1995, 30
 ISO 1234:199, 20
 ISO 12678-1:1996, 13
ISO 128:1982, 10
ISO 128-20:1996, 10
ISO 128-21:1997, 10
 ISO 128-22:1999, 10
 ISO 128-23:1999, 10
 ISO 128-24:1999, 10
 ISO 128-25:1999, 10
ISO 129:1985, 10
ISO 1302:1992, 11
ISO 1328-1:1995, 16
ISO 1328-2:1997, 16
ISO 13565-1:1996, 18
ISO 13565-2:1996, 19
 ISO 13567-1:1998, 13
 ISO 13567-2:1998, 13
ISO 13715:1994, 13
ISO 13920:1996, 15
 ISO 1478:1983, 20
 ISO 1479:1983, 20
 ISO 1481:1983, 20
 ISO 1482:1983, 20
 ISO 1483:1983, 20
ISO 1502:1996, 15
 ISO 15071:1999, 24
 ISO 15226:1999, 14
 ISO 15488:1996, 25
 ISO 1580:1994, 20
ISO 1660:1987, 14
 ISO 1703:1983, 20
 ISO 1711-1:1996, 20
ISO 1829:1975, 14
 ISO 1891:1979, 20
ISO 1964:1987, 30
 ISO 2009:1994, 20
 ISO 2010:1994, 21
 ISO 216:1975, 11
ISO 2162-1:1993, 26
ISO 2162-2:1993, 26
ISO 2162-3:1993, 26
ISO 2203:1973, 26
 ISO 225:1983, 19
ISO 228-1:1994, 15
ISO 228-2:1987, 15
 ISO 2342:1972, 21
 ISO 2351:1986, 21
ISO 2538:1998, 14
ISO 2553:1992, 17
ISO 2594:1972, 11
 ISO 261:1998, 19
 ISO 262:1998, 19
 ISO 263:1973, 19
ISO 2692:1988, 16
ISO 2692:1988 Amd 1:1992, 16
 ISO 272:1982, 19
 ISO 273:1979, 19
ISO 2768-1:1989, 15
ISO 2768-2:1989, 15
ISO 286-1:1988, 14
ISO 286-2:1988, 14
ISO 2903:1993, 15
 ISO 299:1987, 19
ISO 3040:1990, 15
ISO 3098-1:1974, 11
ISO 3098-2:1984, 11
ISO 3098-3:1987, 11
ISO 3098-4:1984, 11
ISO 3098-5:1997, 11
 ISO 3266:1984, 21
 ISO 3269:1988, 21
ISO 3272-1:1983, 11
ISO 3272-2:1994, 11
ISO 3272-3:1975, 11
ISO 3272-4:1994, 11
ISO 3274:1996, 18
 ISO 3408-1:1991, 21
 ISO 3408-2:1991, 21
 ISO 3408-3:1992, 21
 ISO 3506-1:1997, 21
 ISO 3506-2:1997, 21
 ISO 3506-3:1997, 21

- ISO 3508:1976, 21
ISO 3511-1:1977, 30
ISO 3511-2:1984, 30
ISO 3511-3:1984, 30
ISO 3511-4:1985, 30
ISO 370:1975, 14
ISO 3753:1977, 30
ISO 3766:1995, 27
ISO 3952-1:1981, 30
ISO 3952-2:1981, 30
ISO 3952-3:1979, 30
ISO 3952-4:1984, 30
ISO 3971:1977, 30
ISO 4014:1988, 21
ISO 4015:1979, 21
ISO 4016:1988, 21
ISO 4017:1988, 21
ISO 4018:1988, 21
ISO 4026:1993, 21
ISO 4027:1993, 21
ISO 4028:1993, 21
ISO 4029:1993, 22
ISO 4032:1986, 22
ISO 4033:1979, 22
ISO 4034:1986, 22
ISO 4035:1986, 22
ISO 4036:1979, 22
ISO 406:1987, 14
ISO 4063:1998, 17
ISO 4066:1994, 27
ISO 4067-1:1984, 30
ISO 4067-2:1980, 30
ISO 4067-6:1985, 30
ISO 4068:1978, 27
ISO 4069:1977, 27
ISO 4156:1981, 16
ISO 4156:1981 /Amd.1:1992,
16
ISO 4157-1:1998, 27
ISO 4157-2:1998, 27
ISO 4157-3:1998, 27
ISO 4161:1999, 22
ISO 4162:1990, 22
ISO 4172:1991, 27
ISO 4229:1977, 22
ISO 4287:1997, 18
ISO 4288:1996, 18
ISO 4291:1985, 18
ISO 4292:1985, 18
ISO 4468:1982, 16
ISO 4753:1983, 22
ISO 4755:1983, 22
ISO 4757:1983, 22
ISO 4759-1:1978, 22
ISO 4762:1997, 22
ISO 4766:1983, 22
ISO 4775:1984, 22
ISO 5232:1998, 30
ISO 5261:1995, 27
ISO 54:1996, 26
ISO 5436:1985, 18
ISO 5455:1979, 11
ISO 5456-1:1996, 11
ISO 5456-2:1996, 12
ISO 5456-3:1996, 12
ISO 5457:1999, 12
ISO 5458:1998, 17
ISO 5459:1981, 17
ISO 561:1989, 29
ISO 5784-1:1988, 30
ISO 5784-2:1989, 31
ISO 5784-3:1989, 31
ISO 5807:1985, 31
ISO 5845-1:1995, 12
ISO 5845-2:1995, 12
ISO 5859:1991, 31
ISO 5864:1993, 16
ISO 6284:1996, 27
ISO 6318:1985, 18
ISO 6410-1:1993, 12
ISO 6410-2:1993, 12
ISO 6410-3:1993, 12
ISO 6411:1982, 12
ISO 6412-1:1989, 12
ISO 6412-2:1989, 12
ISO 6412-3:1993, 12
ISO 6413:1988, 12
ISO 6414:1982, 28
ISO 6428:1982, 12
ISO 6433:1981, 12
ISO 6790:1986, 31
ISO 68-1:1998, 19
ISO 68-2:1998, 19
ISO 6829:1983, 31
ISO 691:1997, 19
ISO 6931-1:1994, 26
ISO 6931-2:1989, 26
ISO 7045:1994, 23
ISO 7046-1:1994, 23
ISO 7046-2:1990, 23
ISO 7047:1994, 23
ISO 7048:1998, 23
ISO 7049:1983, 23
ISO 7050:1983, 23
ISO 7051:1983, 23
ISO 7053:1992, 23
ISO 7083:1983, 17
ISO 7089:1983, 25
ISO 7091:1983, 25
ISO 7092:1983, 25
ISO 7093:1983, 25
ISO 7094:1983, 25
ISO 7-1:1994, 15
ISO 710-1:1974, 29
ISO 710-2:1974, 29
ISO 710-3:1974, 29
ISO 710-4:1982, 29
ISO 710-5:198, 29
ISO 710-6:1984, 29
ISO 710-7:1984, 29
ISO 7-2:1982, 15
ISO 7200:1984, 12
ISO 724:1993, 19
ISO 7378:1983, 23
ISO 7379:1983, 23
ISO 7380:1997, 23
ISO 7411:1984, 23
ISO 7412:1984, 23
ISO 7413:1984, 23
ISO 7414:1984, 24
ISO 7415:1984, 25
ISO 7417:1984, 24
ISO 7434:1983, 24
ISO 7435:1983, 24
ISO 7436:1983, 24
ISO 7437:1990, 27
ISO 7518:1983, 27
ISO 7519:1991, 27
ISO 7573:1983, 12
ISO 8015:1985, 17
ISO 8048:1984, 27
ISO 8062:1994, 15
ISO 8402:1994, 32
ISO 8458-1:1989, 26
ISO 8458-2:1989, 26
ISO 8458-3:1992, 26
ISO 8560:1986, 27
ISO 8673:1988, 24
ISO 8674:1988, 24
ISO 8675:1988, 24
ISO 8676:1988, 24
ISO 8677:1986, 24
ISO 8678:1988, 24
ISO 8738:1986, 25
ISO 8765:1988, 24
ISO 8785:1998, 18
ISO 8790:1987, 31
ISO 8826-1:1989, 26
ISO 8826-2:1994, 26
ISO 885:1976, 19
ISO 887:1983, 25
ISO 898-1:1988, 19
ISO 898-2:1992, 19
ISO 898-5:1998, 20
ISO 898-6:1994, 20
ISO 898-7:1992, 20
ISO 9000-1:1994, 32
ISO 9000-2:1997, 33
ISO 9000-3:1997, 33
ISO 9000-4:1993, 33
ISO 9001:1994, 33
ISO 9001:1994/Cor 1:1995, 33
ISO 9002:1994, 33
ISO 9002:1994/Cor 1:1995, 33
ISO 9003:1994, 33
ISO 9003:1994/Cor 1:1994, 33
ISO 9003:1994/Cor 2:1995, 33
ISO 9004-1:1994, 33
ISO 9004-2:1991, 33

- ISO 9004-2:1991/Cor 1:1994, 33
ISO 9004-3:1993, 33
ISO 9004-4:1993, 33
ISO 9004-4:1993/Cor 1:1994, 33
[ISO 9175-1:1988](#), 34
[ISO 9175-2:1988](#), 34
[ISO 9176:1988](#), 34
[ISO 9177-1:1989](#), 34
[ISO 9177-2:1989](#), 34
[ISO 9177-3:1994](#), 34
[ISO 9178-1:1988](#), 34
[ISO 9178-2:1988](#), 34
[ISO 9178-3:1989](#), 34
[ISO 9179-1:1988](#), 34
[ISO 9180:1988](#), 34
[ISO 9222-1:1989](#), 13
[ISO 9222-2:1989](#), 13
[ISO 9431:1990](#), 27
[ISO 965-1:1980](#), 15
ISO 965-1:1998, 20
[ISO 965-2:1980](#), 15
ISO 965-2:1998, 20
[ISO 965-3:1980](#), 15
ISO 965-3:1998, 20
ISO 965-4:1998, 20
ISO 965-5:1998, 20
[ISO 9878:1990](#), 31
[ISO 9957-1:1992](#), 34
[ISO 9957-2:1995](#), 34
ISO 9957-3:1997, 34
[ISO 9958-1:1992](#), 34
[ISO 9958-2:1992](#), 34
[ISO 9959-1:1992](#), 35
ISO 9959-2:1999, 35
[ISO 9960-1:1992](#), 35
[ISO 9960-2:1994](#), 35
[ISO 9960-3:1994](#), 35
[ISO 9961:1992](#), 35
[ISO 9962-1:1992](#), 35
[ISO 9962-2:1992](#), 35
[ISO 9962-3:1994](#), 35
ISO/AWI 10110-16, 29
ISO/AWI 11442-1, 31
ISO/AWI 11442-2, 32
ISO/AWI 11442-3, 32
ISO/AWI 11442-4, 32
ISO/AWI 2553, 17
ISO/AWI 286-1, 14
ISO/CD 10110-17, 29
ISO/CD 1219-1, 30
ISO/CD 128-71, 10
ISO/CD 129-2, 11
ISO/CD 2692, 16
ISO/CD 5459-1, 17
ISO/CD 5459-2, 17
ISO/CD 8458-1, 26
ISO/CD 8458-2, 26
ISO/CD 8458-3, 26
ISO/DIS 10110-14, 28
ISO/DIS 10110-15, 29
ISO/DIS 10664, 24
ISO/DIS 10666, 24
ISO/DIS 11442-6, 32
ISO/DIS 11442-7, 32
ISO/DIS 11442-8, 32
ISO/DIS 11442-9, 32
ISO/DIS 128-30.2, 10
ISO/DIS 128-40, 10
ISO/DIS 128-41, 10
ISO/DIS 128-50.2, 10
ISO/DIS 128-60, 10
ISO/DIS 129-1, 10
ISO/DIS 1302, 11
ISO/DIS 1478, 20
ISO/DIS 14985, 13
ISO/DIS 15072, 24
ISO/DIS 15073, 24
ISO/DIS 15480, 25
ISO/DIS 15481, 25
ISO/DIS 15482, 25
ISO/DIS 15483, 25
ISO/DIS 16018, 14
ISO/DIS 3269, 21
ISO/DIS 3408-4, 21
ISO/DIS 3408-5, 21
ISO/DIS 4014, 21
ISO/DIS 4016, 21
ISO/DIS 4017, 21
ISO/DIS 4018, 21
ISO/DIS 4032, 22
ISO/DIS 4033, 22
ISO/DIS 4034, 22
ISO/DIS 4035, 22
ISO/DIS 4036, 22
ISO/DIS 4162, 22
ISO/DIS 4759-1, 22
ISO/DIS 4759-3, 22
ISO/DIS 4775, 23
ISO/DIS 7411, 23
ISO/DIS 7412, 23
ISO/DIS 7413, 23
ISO/DIS 7414, 24
ISO/DIS 7417, 24
ISO/DIS 8673, 24
ISO/DIS 8674, 24
ISO/DIS 8675, 24
ISO/DIS 8676, 24
ISO/DIS 8765, 24
ISO/DIS 887, 25
ISO/DIS 898-1, 19
ISO/DIS 9000, 32
ISO/DIS 9001, 33
ISO/DIS 9004, 33
ISO/FDIS 1101, 16
ISO/FDIS 7089, 25
ISO/FDIS 7091, 25
ISO/FDIS 7092, 25
ISO/FDIS 7093-1, 25
ISO/FDIS 7093-2, 25
ISO/FDIS 7094, 25
[ISO/R 1501:1970](#), 15
[ISO/R 1938:1971](#), 14
[ISO/R 538:1967](#), 29
[ISO/R 784:1968](#), 29
[ISO/TR 10127:1990](#), 27
[ISO/TR 14638:1995](#), 15
[ISO/TR 5460:1985](#), 17
[ISO/TR 7084:1981](#), 27
ISO/TTA 1:1994, 14
ISO/WD 1, 14
ISO/WD 5459-3, 17
NP 107:1962, 3
NP 110:1983, 4
[NP 1515:1977](#), 4
NP 155:1985, 4
[NP 167:1966](#), 3
[NP 189:1962](#), 3
NP 1895:1982, 3
NP 1896:1982, 4
NP 1897:1982, 4
NP 1899:1982, 5
[NP 190:1963](#), 3
NP 1900:1982, 5
[NP 204:1968](#), 3
[NP 205:1970](#), 3
NP 245:1961, 5
NP 246:1961, 5
NP 247:1961, 5
NP 248:1961, 5
NP 249:1961, 5
NP 250:1961, 5
[NP 251:1961](#), 5
NP 252:1961, 5
NP 264:1962, 5
NP 265:1962, 3
[NP 297:1963](#), 3
[NP 327:1964](#), 3
[NP 328:1964](#), 3
NP 366:1964, 3
NP 3915-1:1994, 4
NP 3915-2:1994, 4
[NP 400:1983](#), 4
[NP 401:1983](#), 4
[NP 48:1968](#), 3
[NP 49:1968](#), 3
[NP 62:1961](#), 3
[NP 671:1973](#), 3
[NP 716:1968](#), 3
[NP 718:1968](#), 3